

Document Number CR6849

City of OAKLAND County of ALAMEDA, California

Brief Legal Description PARCEL C OF PARCEL MAP 9645 (322 M 22)

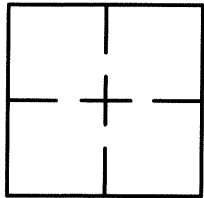

CORNER RECORD

Government Corner ☐ Control ☐
Meander ☐ Property ☒
Rancho ☐ Other ☐
Date of Survey FEBRUARY 2013

COORDINATES
(Optional)

N. _____
E. _____
Zone _____ Datum _____
Elev. _____

Corner — Left as found ☐ Found and tagged ☐ Established ☐ Reestablished ☒ Rebuilt ☐

In conformance with Section 8771 of the Professional Land Surveyors' Act this corner record is being filed to
ESTABLISH _____ / REESTABLISH _____ the position of an existing monument PRIOR _____ / SUBSEQUENT _____
to street or highway reconstruction.

Identification and type of corner found: Evidence used to identify or procedure used to establish or reestablish the corner:

SET CORNER AND LINE POINT OF PARCEL FROM MONUMENTS FOUND IN
GYPSY LANE

A description of the physical condition of the monument as found and as set or reset: _____

SET 1/2" REBAR W/ CAP STAMPED "LS 4210"

SET NAIL W/ TAG STAMPED "LS 4210"

SURVEYOR'S STATEMENT

This Corner Record was prepared by me or under my direction in conformance with

the Land Surveyors' Act on OCTOBER 27, 20 14.

Signed Vincent D' Alo L.S. Number LS 4210

COUNTY SURVEYOR'S STATEMENT

This Corner Record was received 12-17- 20 14 and examined

and filed 1-26- 20 15.

Signed Russell R. Penland Title County Surveyor

County Surveyor's Comment _____

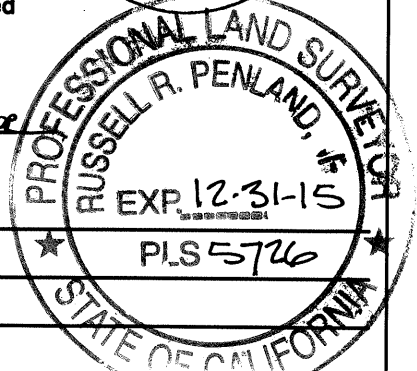

KK11Z4

