

CORNER RECORD

Agency Index

133

80

Document Number CR 14226

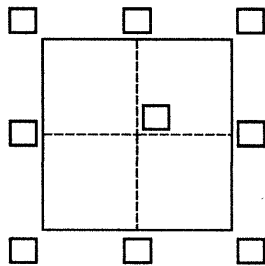
City of OAKLAND County of ALAMEDA, CaliforniaBrief Legal Description MONUMENT AT THE INTERSECTION OF E. 14th AND 104th AVE**CORNER TYPE**

Government Corner ☒ Control
Meander ☐ Property
Rancho ☐ Other

Date of Survey January 7, 2020**COORDINATES (Optional)**

N. _____ E. _____

Elevation _____

Units Metric ☐ U.S. Survey Foot ☒

Horizontal Datum _____

Zone _____ Epoch Date _____

Vertical Datum _____

☐ Complies with Public Resources Code §§8801-8819☐ Complies with Public Resources Code §§8890-8902

PLS Act Ref.:

☐ 8765(d)☒ 8771☐ 8773☐ Other:**Corner/
Monument:**☐ Left as found☐ Established☐ Rebuilt☐ Pre-Construction☐ Found and tagged☐ Reestablished☐ Referenced☒ Post-Construction

Narrative of corner identified and monument as found, set, reset, replaced, or removed:

☐ See sheet #2 for description(s):

MONUMENT HAD NOT BEEN DISTURBED DURING CONSTRUCTION
SEE PRE-CONSTRUCTION CORNER RECORD CR 12127

SURVEYOR'S STATEMENT

This Corner Record was prepared by me or under my direction in conformance with

the Professional Land Surveyors' Act on April 8, 2020

Signed

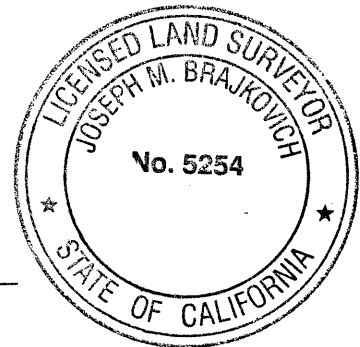
P.L.S. or R.C.E. No. P.L.S. 5254**COUNTY SURVEYOR'S STATEMENT**

This Corner Record was received

APR 15 2020

and examined and filed

APR 15 2020

Signed

P.L.S. or R.C.E. No.

7010Title ALAMEDA COUNTY SURVEYOR

County Surveyor's Comment





SCALE
1"=20'

HW57P5

2086332.93
6087384.19

N7°43'45"E
19.00

140TH AVE

N61°23'38"W
36.10

N84°16'44"W
27.76

EAST 14TH ST

SEE PER-CONSTRUCTION CR 12127

LEGEND



PIN IN MONUMENT WELL



CUT CROSS

AA##A#

ALAMEDA CO MON ID