

CITY OF ANAHEIM ELECTRICAL NOTE

THERE ARE EXISTING 69KV, 12KV AND STREETLIGHT OVERHEAD AND UNDERGROUND ELECTRICAL FACILITIES WITHIN THE PROJECT'S BOUNDARY. PLEASE PROTECT ALL ABOVEGROUND AND UNDERGROUND ELECTRICAL FACILITIES IN PLACE AND CONTACT UTILITY INSPECTOR JEFF ROBISON AT 714-292-8881 PRIOR TO WORKING WITHIN PROXIMITY TO ENERGIZE ELECTRICAL FACILITIES.

ANY ADJUSTMENTS OF ELECTRICAL PULLBOXES AND VAULTS TO FINAL GRADE, PLEASE COORDINATE WITH UTILITY INSPECTOR AT LEAST 48 HOURS PRIOR TO THE PLANNED WORK. MAINTAIN ALL CLEARANCES PER GENERAL ORDER 95 AND 128. ANY PROPOSED ELECTRICAL PULLBOXES/VAULTS/POLES REQUIRING RELOCATION REQUIRED, PLEASE CONTACT VINH TRAN AT 714-765-4273.

PROFILE SCALE

HORIZ. 1"=20'
VERT. 1"= 2'

CONSTRUCTION NOTES

- EXCAVATE FOR PROPOSED STRUCTURAL SECTION AND IMPROVEMENTS.
- CONSTRUCT 7" AC, INCLUDED 2" THICK ARHM SURFACE COURSE OVER 14" CLASS II AB.
- COLD MILL 4" THICK EXISTING AC PAVEMENT.
- CONSTRUCT 4" AC, INCLUDES 2" THICK ARHM SURFACE COURSE.
- REMOVE AND RECONSTRUCT CURB & GUTTER PER CITY OF FULLERTON STD PLAN NO. 120, TYPE A. (VARIABLE CF) TO MATCH EXIST. TOP OF CURB.
- CONSTRUCT CURB PER CITY OF FULLERTON STD PLAN NO. 120, TYPE B-1 (6"CF).
- CONSTRUCT CONC. SIDEWALK PER CITY OF FULLERTON STD PLAN NO. 122.
- REMOVE AND RECONSTRUCT DRIVEWAY APPROACH (COMMERCIAL) PER CITY OF FULLERTON STD PLAN 121-2. CONCRETE TO BE HIGH EARLY STRENGTH CONCRETE CONCRETE MIX W/COMP. STRENGTH OF 3000 PSI IN 24 HOURS.
- REMOVE EXIST. IMPROVEMENTS AND RECONSTRUCT SIDEWALK PER CITY OF ANAHEIM STD PLAN 110-B.
- REMOVE AND RECONSTRUCT CURB & GUTTER PER CITY OF ANAHEIM STD PLAN 120, TYPE A, 8" CF.
- ADJUST EXIST. MANHOLE TO GRADE PER CITY OF FULLERTON STD PLAN 204.
- ADJUST EXIST. FIBER OPTIC PULL BOX TO GRADE AND RELOCATE EXIST. FIBER OPTIC CABINET(BY OTHERS).
- REGRADE AND REPLACE DROUGHT TOLERANT LANDSCAPING TO MATCH EXISTING. (FEATHER TO JOIN EXISTING)
- CONSTRUCT CMU SLOUGH WALL PER DETAIL SHEET 3.
- REMOVE EXISTING RECTANGULAR CONCRETE CHANNEL DRAIN, STEEL PLATE AND RECONSTRUCT PARKWAY CULVERT-TYPE B, PER CITY OF FULLERTON STD PLAN 128, S=5'
- CONSTRUCT CURB DRAIN PER APWA STD PLAN 150-4 (N=1).
- CONSTRUCT 6" PCC OVER NATIVE. CONCRETE TO BE HIGH EARLY STRENGTH CONCRETE MIX W/COMP. STRENGTH OF 3000 PSI IN 24 HOURS.
- ADJUST EXIST. WATER VALVE TO GRADE.
- EXISTING TREE TO BE REMOVED BY OTHERS.
- REMOVE EXISTING BUSH.

DISPOSITION NOTE

- PROTECT IN PLACE

LEGEND

- 2" COLD MILL AND 2" AC OVERLAY
- 4" AC INCLUDES 2" AC SURFACE COURSE
- 7" AC INCLUDES 2" AC SURFACE COURSE OVER 14" CLASS II AB

THESE PLANS WERE PREPARED UNDER THE SUPERVISION OF:



SIGNATURE DATE

REVISIONS

NUMBER	DESCRIPTION	DATE	DRAWN	INITIALS	DATE
	DESIGNED		NC		04/24
	REVIEWED		SD		04/24
	STREET				
	SEWER				
	DRAINAGE				
	WATER				
	TRAFFIC				
	UTILITY/ELEC				
	LANDSCAPE				
	FACILITIES				
	GENERAL ENG				
	DESIGN ENG				
	INSPECTION				
	PAVING & REC				
	AS-BUILT				

CITY OF FULLERTON
PUBLIC WORKS DEPARTMENT

ORANGETHORPE AVENUE RECONSTRUCTION PROJECT
CIP PROJECT

STREET IMPROVEMENTS-ORANGETHORPE AVE
FROM STA. 20+00 TO STA. 25+00

APPROVED:

DATE CITY ENGINEER/ASSISTANT PUBLIC WORKS DIRECTOR

ACCEPTED:

DATE PUBLIC WORKS DIRECTOR

SCALE: 1" = 20'

CITY OF FULLERTON BM NO.: 35-37 ELEV = 173.90'
B.M.: P.K. NAIL IN LEAD, N.E. COR. RAYMOND AND WILSHIRE, E.
CURB OF RAYMOND, 1" N. OF E.C.B.

SHEET 15 OF 21 SHEETS

FILE: 7082

STA. 20+00-MATCH LINE-SEE SHEET 14

STA. 25+00-MATCH LINE-SEE SHEET 16

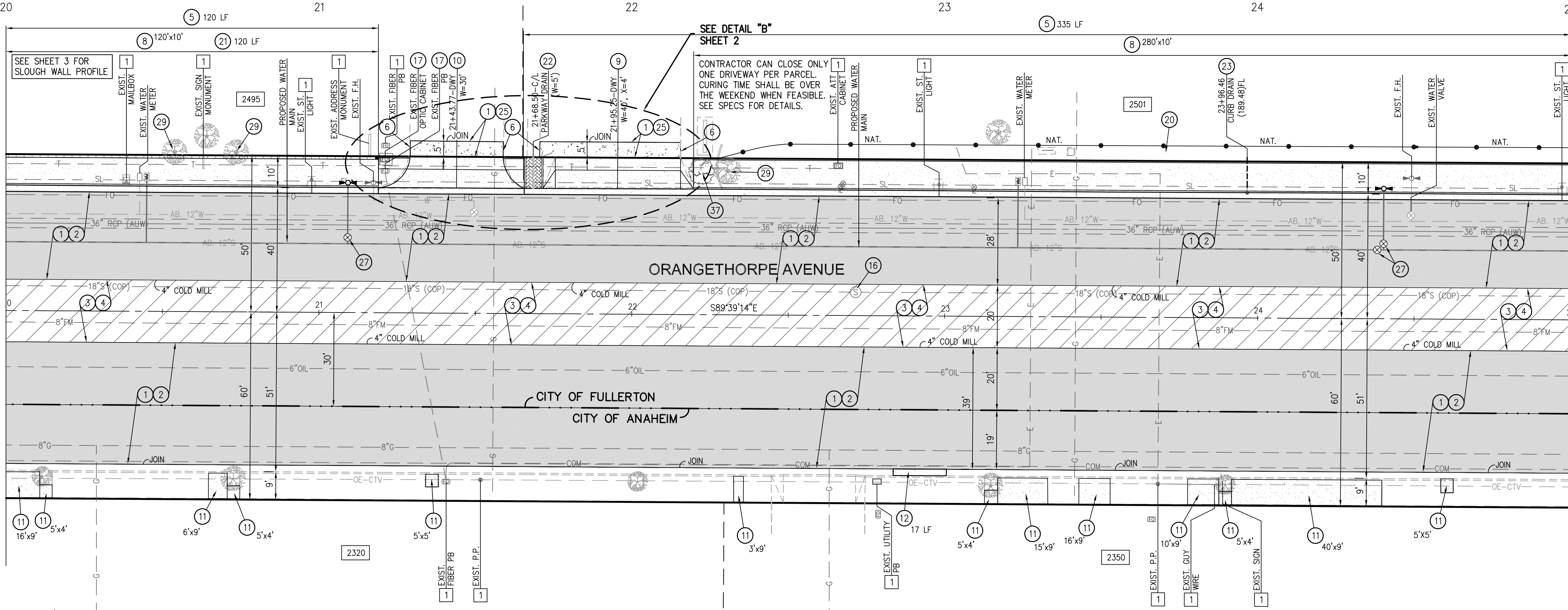

GRAPHIC SCALE

