

LIGHTING FIXTURE SCHEDULE

PROVIDED FOR INFORMATION ONLY.
VERIFY AND INSTALL PER ELECTRICAL DRAWING

ITEM	SYMBOL	DESCRIPTION	QTY.	MFR. & CAT. NO.	REMARK
INTERIOR LIGHTING ITEM					
L1		EDGE-LIT LED PANEL 120-277V UE - UNIVERSAL VOLTAGE		MANUFACTURER: LSI FIXTURE: SPF24-LED-50-UE-DIM-35 LED 5000 LUMENS, 3500K COLOR	KITCHEN CEILING LIGHTS. FURNISHED BY LICENSEE / INSTALLED BY G.C.
L1EM		2X4 EDGE-LIT LED PANEL 120-277V UE - UNIVERSAL VOLTAGE		MANUFACTURER: LSI FIXTURE: SPF24-LED-50-UE-DIM-35 LED 5000 LUMENS, 3500K COLOR	EMERGENCY KITCHEN CEILING LIGHTS FURNISHED BY LICENSEE/ INSTALLED BY GC
		NOT USED			
L2		2X2 EDGE-LIT LED PANEL (SURFACE MOUNT) 120-277V UE - UNIVERSAL VOLTAGE		MANUFACTURER: LSI FIXTURE: SPF24-LED-50-UE-DIM-35 LED 5000 LUMENS, 3500K COLOR	KITCHEN CEILING LIGHTS. FURNISHED BY LICENSEE / INSTALLED BY G.C.
L4		UNIVERSAL MOUNT EXIT SIGN, LED LIGHTED, 120V WITH BATTERY PACK, 2 FACE, GREEN LETTER		JUNO, NAVILTE, NIBLHO THERMOPLASTIC EMERGENCY LIGHT	EXIT SIGN FURNISHED BY G.C./ INSTALLED BY GC
L6B		WALK-IN COOLER FLUORESCENT LIGHT, 120 V 48"		KASON FIXTURE: # 18180F00048	FURNISHED BY WIC VENDOR, INSTALLED BY G.C.
L19		DOWN LIGHT, RECESSED IN CEILING		ELITE HOUSING: LD6IC-AT LED MODULE: ELITE LED LIGHTING RL607-14W-120-FL-27K-W-WH	FURNISHED BY LICENSEE/ INSTALLED BY GC
L19EM		EMERGENCY DOWN LIGHT, RECESSED IN CEILING		ELITE HOUSING: LD6IC-AT LED MODULE: ELITE LED LIGHTING RL607-14W-120-FL-30K-SN-SN	EMERGENCY RECESSED DOWN LIGHT - NORMALLY ON INVERTER UNIT - ISOLITE, IMI-12-LC-V1 FURNISHED BY LICENSEE/ INSTALLED BY GC
L6A		HOOD LIGHT		FURNISHED & INSTALLED BY EQUIPMENT SUPPLIER	LIGHTS SUPPLIED & PRE-WIRED BY HOOD VENDOR. ELECTRIC CONTRACTOR TO CONNECT MAIN WIRES TO SHUNT TRIP BREAKER AND HOOD CONTROL PANEL
L20		LED MR16 DOWN LIGHT, RECESSED IN CEILING		HOUSING: LIGHTOLIER LYTECASTER 302MRSPX TRIM: LIGHTOLIER LYTECASTER 378MWHK (WHITE) BULB: LED MR16 MANUFACTURER: GE PRODUCT CODE: 35535	
		NOT USED			
L23		LED TAPE LIGHT		NORA LIGHTING (OR APPROVED EQUAL) 24V HIGH OUTPUT LED TAPE LIGHT LENGTH: 10FT ROLL/ CCT/CRI: 2700K/ 90CRI LUMENS: 350lm/ 4.2W PER FOOT	

CEILING SCHEDULE

INSTALLED AND FURNISHED BY: G.C. UNLESS NOTED OTHERWISE

NO	MANUFACTURER	DESCRIPTION	MATERIAL	FINISH
C2	USG	2' X 4' SUSPENDED T-BAR GRID CEILING SYSTEM	*VINYL ROCK* VINYL CLAD GYP. BD PANELS	SMOOTH AND WASHABLE WHITE
C3	GOLD BOND	MONOLITHIC CEILING ON METAL FRAMING	5/8" GYP. BD.	SMOOTH PAINT (SEE SCHEDULE)

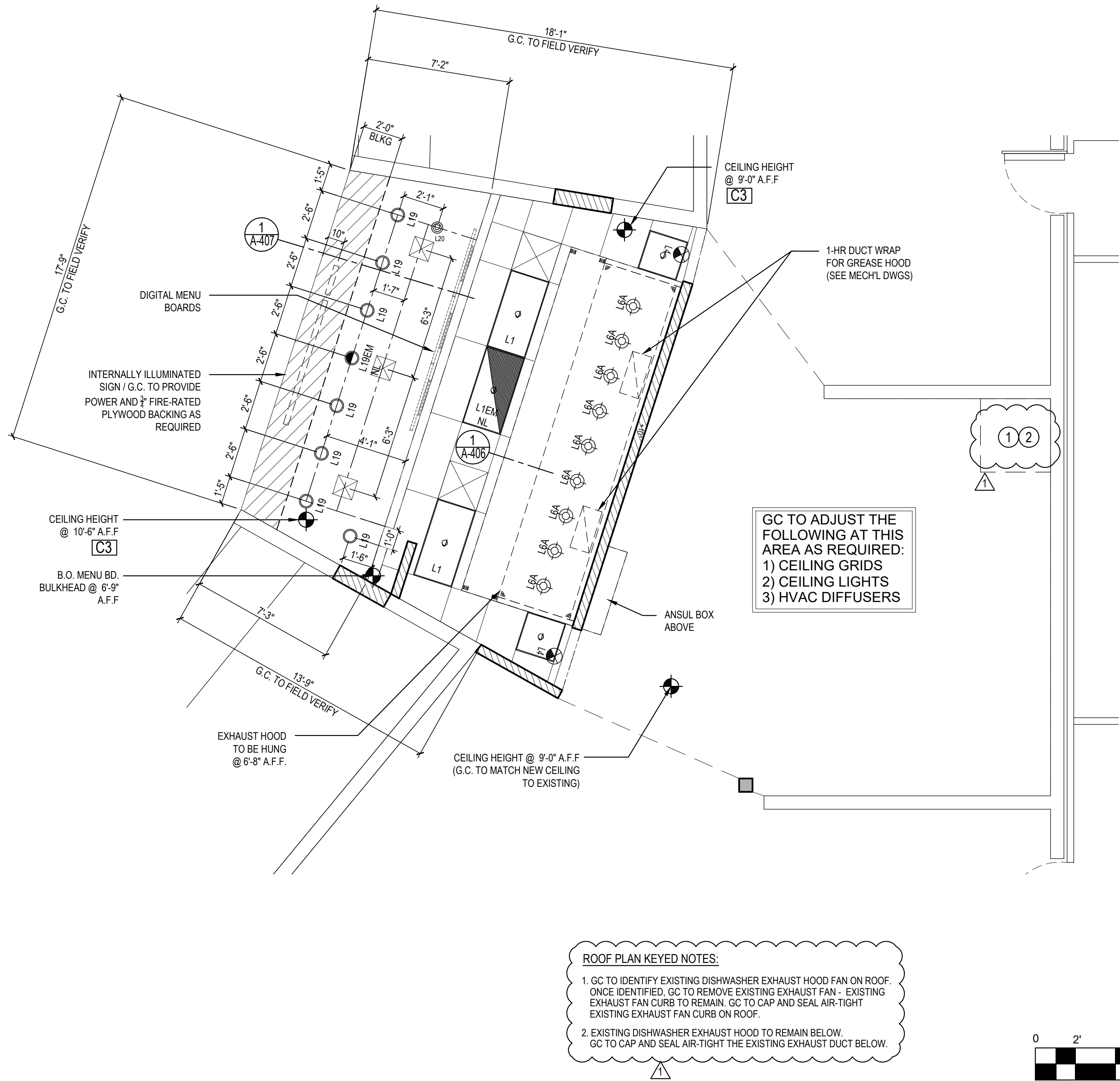

ROOF PLAN KEYED NOTES:

- GC TO IDENTIFY EXISTING DISHWASHER EXHAUST HOOD FAN ON ROOF. ONCE IDENTIFIED, GC TO REMOVE EXISTING EXHAUST FAN - EXISTING EXHAUST FAN CURB TO REMAIN. GC TO CAP AND SEAL AIR-TIGHT EXISTING EXHAUST FAN CURB ON ROOF.
- EXISTING DISHWASHER EXHAUST HOOD TO REMAIN BELOW. GC TO CAP AND SEAL AIR-TIGHT THE EXISTING EXHAUST DUCT BELOW.

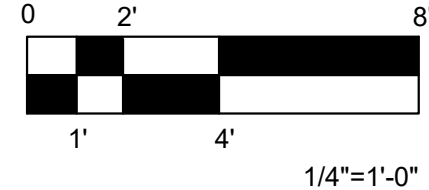

SCHEDULES

2

NTS

A-105

REFLECTED CEILING PLAN

1

Scale = 1/4" = 1'-0"

A-105



PANDA RESTAURANT GROUP INC.

1683 Walnut Grove Ave.
Rosemead, California
91770

Telephone: 626.799.9898
Facsimile: 626.372.8288

All ideas, designs, arrangement and plans indicated or represented by this drawing are the property of Panda Express Inc. and were created for use on this specific project. None of these ideas, designs, arrangements or plans may be used by or disclosed to any person, firm, or corporation without the written permission of Panda Express Inc.

REVISIONS:

NO.	PLAN REVIEW COMMENTS	DATE
1		01/14/2022
2		
3		
4		
5		
6		
7		
8		
9		
10		

ISSUE DATE:

1	35% SUBMITTAL	10/20/2021
2	95% SUBMITTAL	11/15/2021
3	100% RESUBMITTAL	01/21/2021
4		
5		
6		
7		
8		
9		
10		

DRAWN BY: STAFF

PANDA PROJECT #:

ARCH PROJECT #:



GARY WANG
& ASSOCIATES, INC.

1000 Corporate Center Dr., Ste. 550
Monterey Park, CA 91754
TEL: (626) 288-6898 FAX: (626) 768-7101
http://www.garywang.com

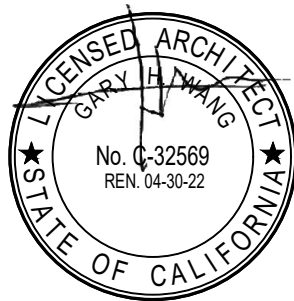

PANDA EXPRESS

SPACE 8126
EXCHANGE FOOD COURT
FT LEONARD WOOD, MO

A-105

REFLECTED CEILING PLAN