



PANDA EXPRESS, INC.
1683 Walnut Grove Ave.
Rosemead, California
91770
Telephone: 626.799.9898
Facsimile: 626.372.8288

All ideas, designs, arrangement and plans indicated or represented by this drawing are the property of Panda Express Inc. and were created for use on this specific project. None of these ideas, designs, arrangements or plans may be used by or disclosed to any person, firm, or corporation without the written permission of Panda Express Inc.

REVISIONS:

| | |
|--|--|
| | |
| | |
| | |
| | |
| | |
| | |
| | |
| | |
| | |
| | |

ISSUE DATE:

04/27/21 WALMART REVIEW
05/05/21 ISSUE FOR PERMIT

| | |
|--|--|
| | |
| | |
| | |
| | |
| | |
| | |
| | |
| | |
| | |
| | |

DRAWN BY:

PANDA PROJECT #: S8-22-D8044
PANDA STORE #: D8044
ARCH PROJECT #: Q511070001

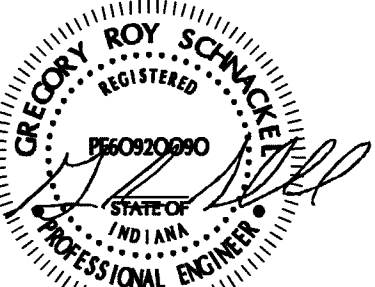

Date: 05/05/21 05-05-21



PANDA EXPRESS
TRUE WARM & WELCOME
STATE ST. & NEW RD.
GREENFIELD, IN 46140

E-102

SECURITY CAMERA PLAN

TRUE WARM & WELCOME 2300 R5

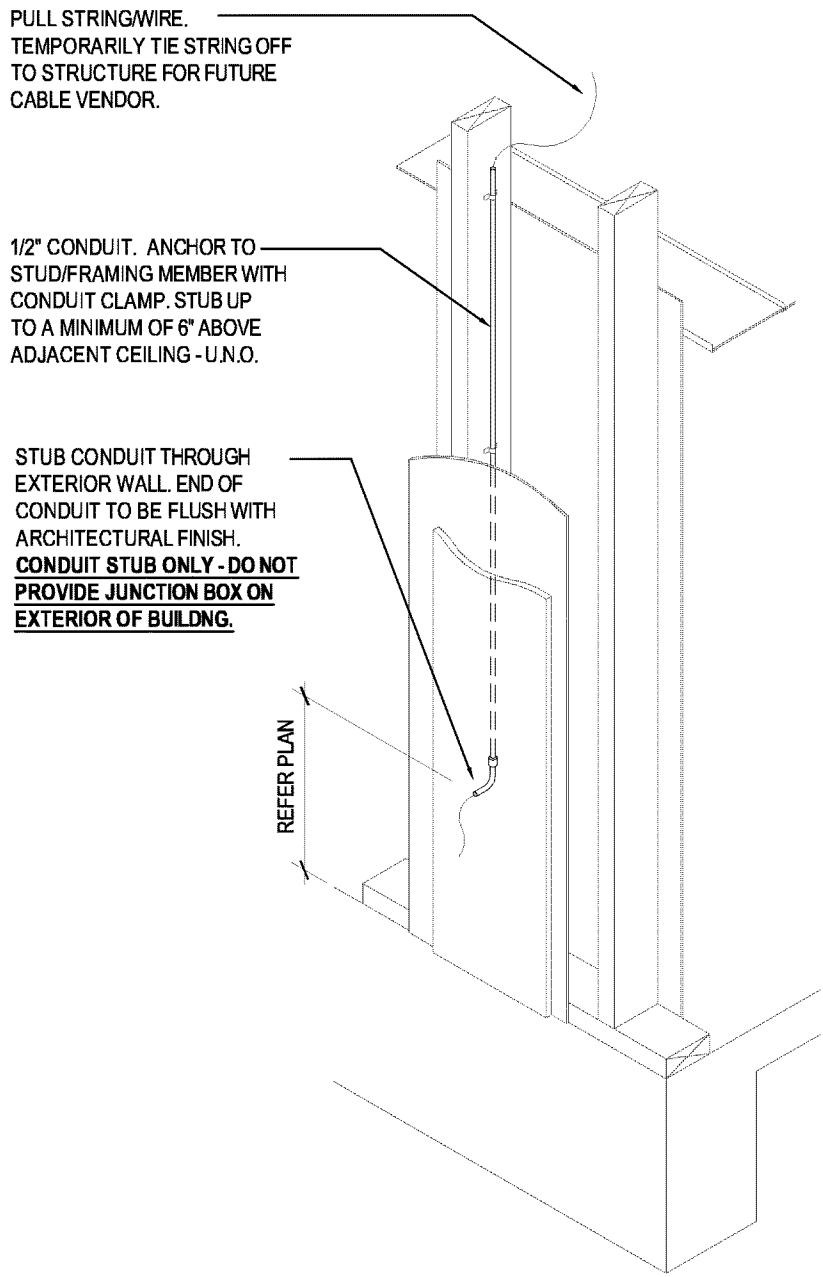
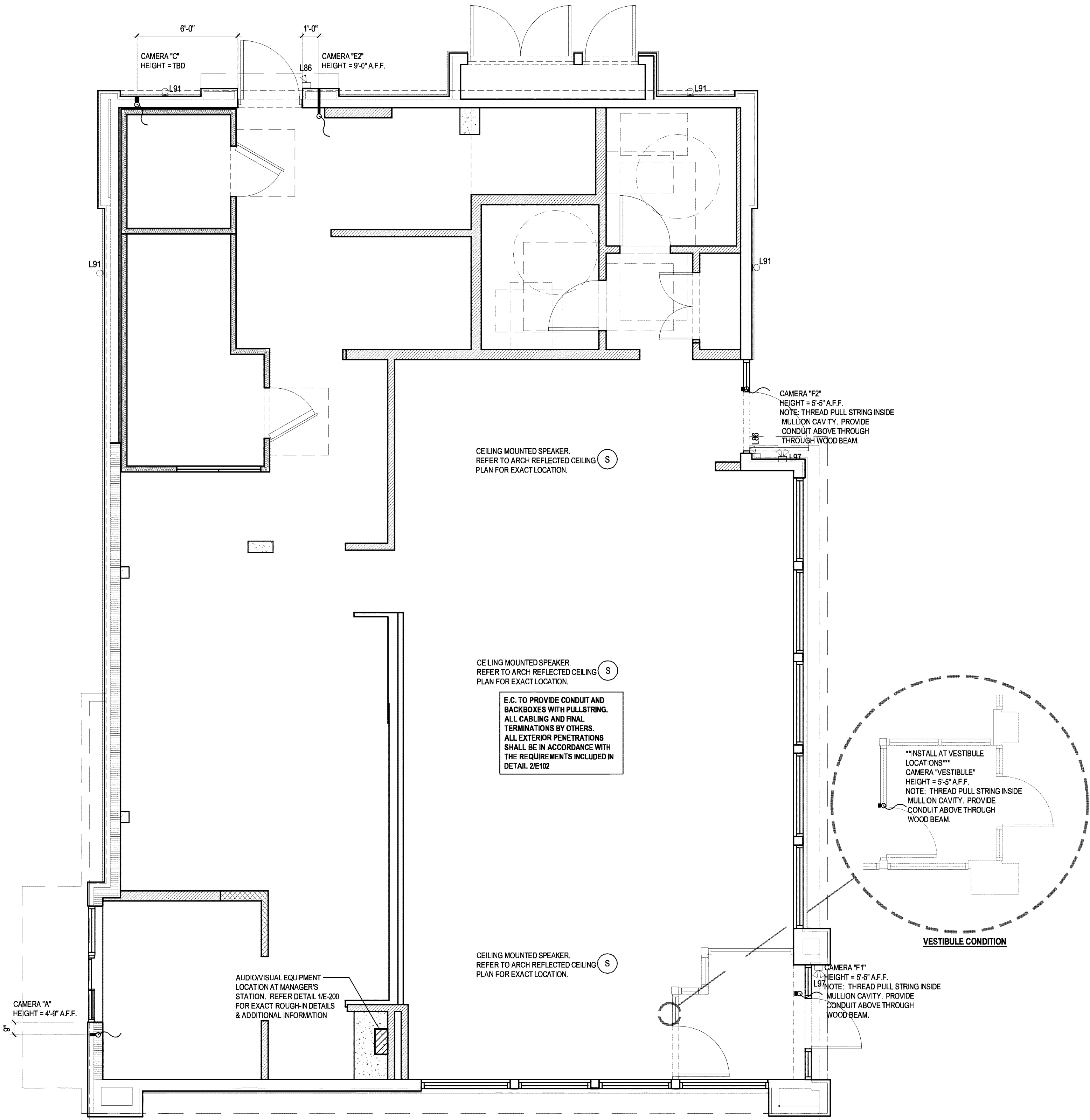

CONDUIT ROUGH-IN DETAIL 2
NOT TO SCALE E-102

SECURITY CAMERA PLAN 1
Scale= 1/4" = 1'-0" E-102