

# MAP OF

## RE-SURVEY

BLOCK "E" LEEVING TOWNSITE- S. 9 T. 1 N. R. 26 E. M. D. B & M,

MONO COUNTY CALIFORNIA

SCALE- 1-INCH=50- FEET

APPROVED BY THE BOARD OF SUPERVISORS

OCT. 1 1934

CHAIRMAN OF BOARD W. H. Evans.

COUNTY-SURVEYOR W. H. Evans.

FILED OCT. 1 1934

Geo. C. Delury Jr  
COUNTY RECORDER

AUG-10-1934

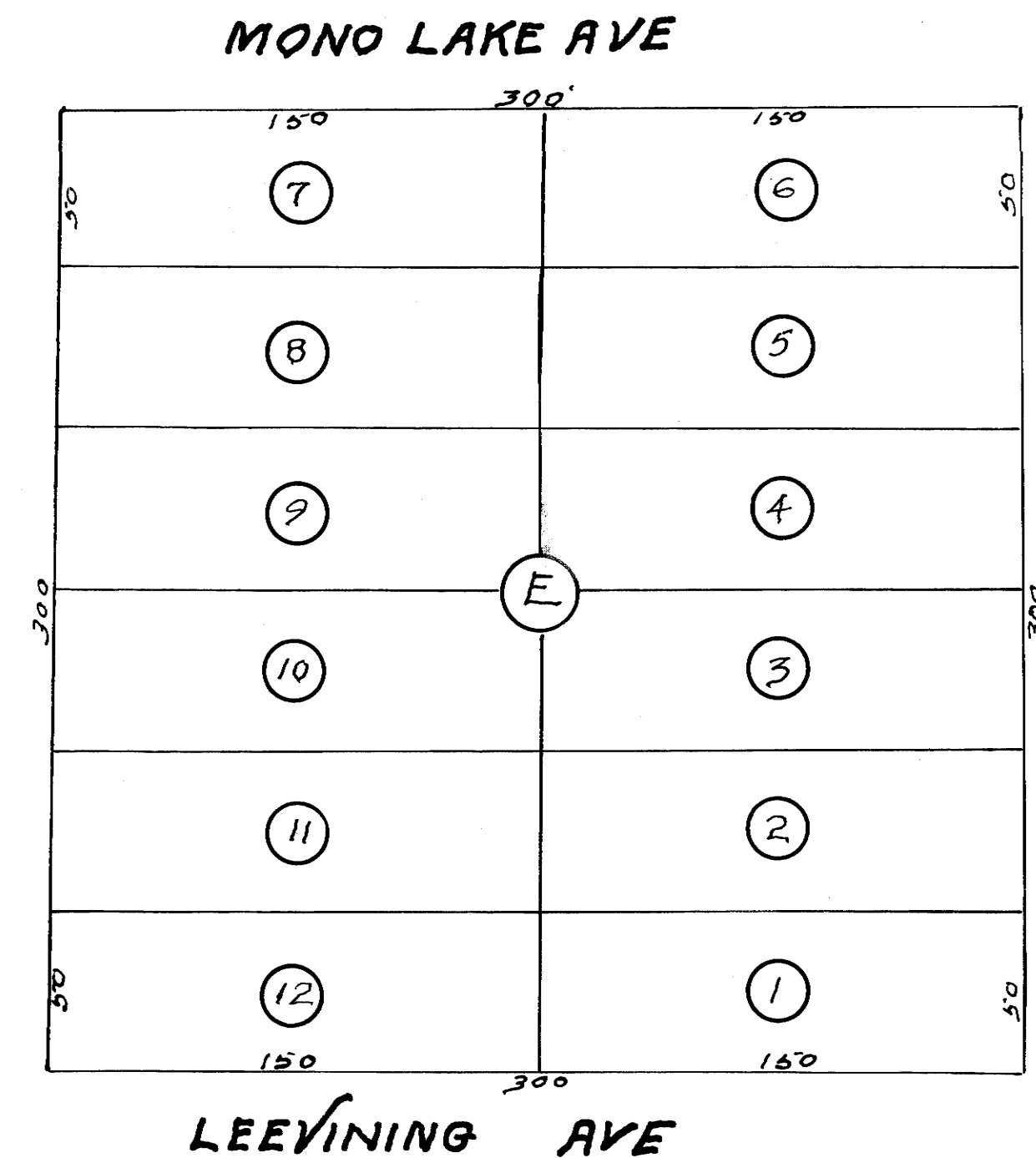

W. H. Evans  
County Surveyor